

Legend: ● Standard ▲ Optional

# MRX Series Pedestal Rock Breaker System

## BOOM & HAMMER COMBINATIONS

### Hammer Specifications

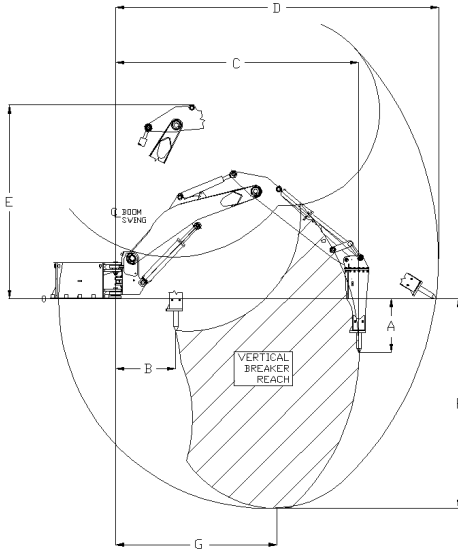

Hammer Models:	BX40	BXR50	BXR65	BXR85
<b>Impact Energy Class:</b> ft-lb (J)	4000 (5423)	5000 (6779)	6500 (8812)	8500 (11524)
<b>Operating Weight:</b> lb. (kg.)	3749 (1700)	3880 (1760)	4563 (2070)	6463 (2931)
<b>Working Length</b> in. (mm)	108.8 (2764)	107.0 (2718)	110.8 (2813)	127.6 (3240)
<b>Tool Diameter</b> in. (mm)	5.1 (135)	5.5 (140)	5.9 (150)	6.3 (160)
<b>Operating Flow</b> gpm (lpm)	29-42 (110-160)	38-54 (144-204)	42-60 (158-227)	52-75 (197-284)
<b>Operating Pressure</b> psi (bar)	1885-2465 (120-170)	2180-2760 (150-190)	2180-2760 (150-190)	2180-2760 (150-190)
<b>Impact Frequency</b> bpm (short stroke)	380-600	374-611 (514-840)	341-561 (454-746)	328-544 (436-723)
<b>Sound / Distance*</b> at 85 dB(A): ft. (m)	135 (41)	142 (43)	146 (44)	150 (45)

(\*): BX & BXR hammers are furnished with a sound suppressing housing for superior noise attenuation. Noise levels may vary due to site conditions and barriers.

### Coverage

	MRX24				MRX30				MRX3036				MRX36	
ft. (m)	BX40	BXR50	BXR65	BXR85	BX40	BXR50	BXR65	BXR85	BX40	BXR50	BXR65	BX40	BXR50	BXR65
<b>A</b>	4'-6" (1.4)	4'-6" (1.4)	5'-0" (1.5)	6'-7" (2.0)	5'-7" (1.7)	5'-7" (1.7)	6'-2" (1.9)	7'-9" (2.4)	5'-7" (1.7)	5'-7" (1.7)	6'-2" (1.9)	5'-7" (1.7)	5'-7" (1.7)	6'-2" (1.9)
<b>B</b>	5'-9" (1.7)	5'-9" (1.7)	6'-0" (1.8)	6'-2" (1.9)	6'-7" (2.0)	6'-7" (2.0)	6'-10" (2.0)	7'-0" (2.1)	7'-7" (2.3)	7'-9" (2.3)	7'-11" (2.4)	8'-6" (2.6)	8'-10" (2.7)	9'-0" (2.7)
<b>C</b>	24'-3" (7.4)	24'-3" (7.4)	24'-6" (7.5)	24'-8" (7.5)	30'-0" (9.1)	30'-3" (9.2)	30'-3" (9.2)	30'-5" (9.3)	33'-0" (10.0)	33'-3" (10.1)	33'-3" (10.1)	36'-0" (11.0)	36'-3" (11.0)	36'-3" (11.0)
<b>D</b>	32'-4" (9.9)	32'-4" (9.9)	32'-9" (10.0)	33'-10" (10.3)	38'-6" (11.7)	38'-8" (11.8)	38'-11" (11.9)	40'-0" (12.2)	42'-4" (12.9)	42'-4" (12.9)	42'-9" (13.0)	44'-10" (13.8)	44'-10" (13.8)	45'-3" (13.8)
<b>E</b>	17'-2" (5.2)	17'-2" (5.2)	17'-2" (5.2)	17'-2" (5.2)	21'-6" (6.6)	21'-6" (6.6)	21'-6" (6.6)	21'-6" (6.6)	21'-6" (6.6)	21'-6" (6.6)	21'-6" (6.6)	30'-0" (9.1)	30'-0" (9.1)	30'-0" (9.1)
<b>F</b>	20'-11" (6.2)	20'-11" (6.2)	21'-6" (6.6)	23'-1" (7.0)	27'-3" (8.3)	27'-3" (8.3)	27'-10" (8.5)	29'-7" (9.0)	28'-1" (8.6)	28'-1" (8.6)	30'-9" (9.4)	28'-10" (9.2)	28'-10" (9.2)	31'-11" (9.7)
<b>G</b>	14'-10" (4.5)	15'-1" (4.6)	15'-1" (4.6)	15'-3" (4.6)	16'-0" (4.9)	16'-3" (5.0)	16'-3" (5.0)	16'-5" (5.0)	17'-0" (5.2)	17'-3" (5.3)	17'-3" (5.3)	17'-9" (5.4)	18'-0" (5.5)	18'-0" (5.5)

### Tool Selection (for aggregate production and mining)



- **Blunt** is used for boulder and oversize breaking; tool impact delivers the stress wave generated by the hammer causing the material to fracture; excellent wear resistance



- **Chisel** is suitable for slabby, angular material; tool provides wedge effect impact and good penetration



- **Moil** is ideal for softer, abrasive material where high penetration is needed; similar to the blunt it results in less torque in the front head

### Concave Removal Tool

For Gyratory Crusher

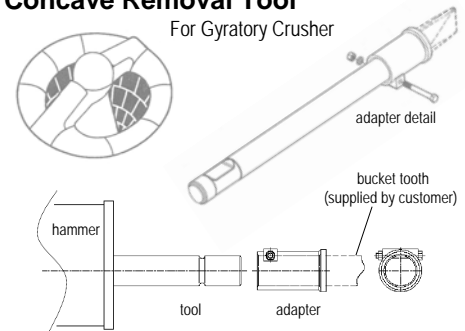

# MRX Series Pedestal Rock Breaker System

## HAMMER SELECTION GUIDE FOR BLASTED MATERIAL\*

### IMPERIAL MEASUREMENTS

	BOULDER SIZE - yd <sup>3</sup>						
Material Hardness Compressive Strength	< 0.5 yd <sup>3</sup>	0.5 – 1.0 yd <sup>3</sup>	1.0 – 2.0 yd <sup>3</sup>	2.0 – 4.0 yd <sup>3</sup>	4.0 – 6.0 yd <sup>3</sup>	6.0 – 8.0 yd <sup>3</sup>	8.0 – 10 yd <sup>3</sup>
Very Hard..... 35-45 ksi examples: gneiss, schist, andesite, gold ore	2,000 ft-lb	3,000 ft-lb	4,000 ft-lb	5,000 ft-lb	6,500 ft-lb	8,500 ft-lb	10,000 ft-lb
Hard..... 25-35 ksi examples: siliceous limestone, basalt, granite, trap rock, copper ore	1,500 ft-lb	2,000 ft-lb	3,000 ft-lb	4,000 ft-lb	5,000 ft-lb	6,500 ft-lb	8,500 ft-lb
Medium Hard... 15-25 ksi examples: dolomite, siliceous and dolomitic limestone	1,000 ft-lb	1,500 ft-lb	2,000 ft-lb	3,000 ft-lb	4,000 ft-lb	5,000 ft-lb	6,500 ft-lb
Soft..... 10-15 ksi examples: soft limestone, gypsum	800 ft-lb	1,000 ft-lb	1,500 ft-lb	2,000 ft-lb			

(\*): 1 ksi = 1,000 psi (lbs. / in.<sup>2</sup>), ranges provided due to possible layer presence and density variance.

### METRIC MEASUREMENTS

	BOULDER SIZE - m <sup>3</sup>						
Material Hardness Compressive Strength	< 0.5 m <sup>3</sup>	0.5 – 1.0 m <sup>3</sup>	1.0 – 2.0 m <sup>3</sup>	2.0 – 4.0 m <sup>3</sup>	4.0 – 6.0 m <sup>3</sup>	6.0 – 8.0 m <sup>3</sup>	8.0 – 10.0 m <sup>3</sup>
Very Hard..... 241-310 MPa examples: gneiss, schist, andesite, gold ore	3,000 ft-lb	4,000 ft-lb	5,000 ft-lb	6,500 ft-lb	8,500 ft-lb	10,000 ft-lb	12,000 ft-lb
Hard..... 172-241 MPa examples: siliceous limestone, basalt, granite, trap rock, copper ore	2,000 ft-lb	3,000 ft-lb	4,000 ft-lb	5,000 ft-lb	6,500 ft-lb	8,500 ft-lb	10,000 ft-lb
Medium Hard.. 103-172 MPa examples: dolomite, siliceous and dolomitic limestone	1,500 ft-lb	2,000 ft-lb	3,000 ft-lb	4,000 ft-lb	5,000 ft-lb	6,500 ft-lb	8,500 ft-lb
Soft..... 69-103 MPa examples: soft limestone, gypsum	1,000 ft-lb	1,500 ft-lb	2,000 ft-lb	3,000 ft-lb			

(\*): 1 MPa = 145 psi (lbs. / in.<sup>2</sup>), ranges provided due to possible layer presence and variance.

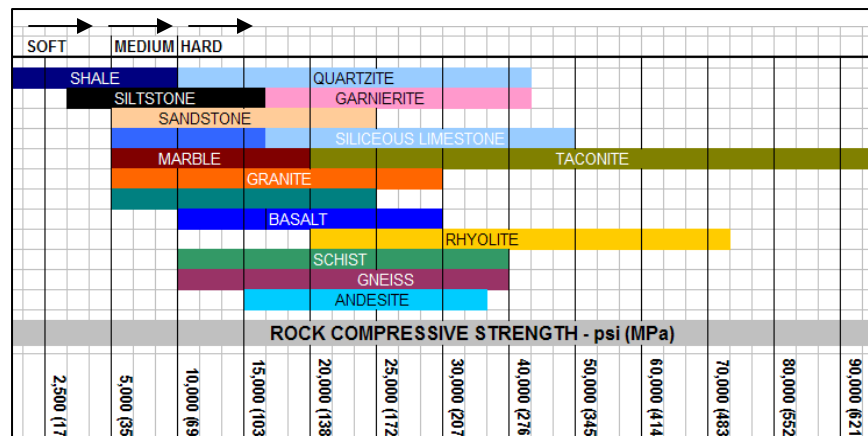

# MRX Series Pedestal Rock Breaker System

## DESIGN and ENGINEERING DATA

### Design Data: in (mm)

- Mounting bolt size: 1.5 in. dia. (Ø 38) x15 thru holes @ 1.75 in. dia. (Ø 44)
- Mounting bolt torque: 450 ft-lb (610 N-M) dry
- Swing Angle: 170° (-85° / +85°) ●

### Pivot Pin Data: in. (Ø mm)

- 4.0 (Ø 102) Swing Post to Boom; Boom-to-Dipperstick (Jib)
- 3.0 (Ø 76): Hammer Mounting

### Cylinder data: Bore Ø / Rod Ø / Stroke

- Hoist (lift): 6.0 / 3.50 / 48.5 (152 / 89 / 1232)
- Stick (crowd): 6.0 / 3.50 / 48.5 (152 / 89 / 1232)
- Tilt (curl): 6.0 / 3.50 / 48.5 (152 / 89 / 1232)

### Cylinder mounting pins

- 3.0 (76)
- 3.0 (76)
- 3.0 (76)

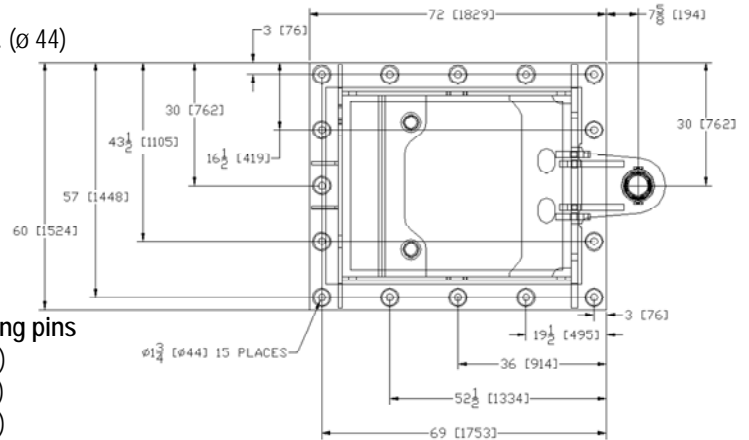

Pedestal Base Dimension: MRX24 – MRX30 – MRX3036 – MRX36

## Engineering Data: Loads and Moments

### Imperial

#### Static Overturning

##### Moments: ft-lb (+/-)

MH\*: 610,000 / 0  
MV: 75,400 / 75,400  
MS\*: 610,000 / 610,000

##### Loads: lbs. (+/-)

FS\*: 14,000 / 14,000  
FV: 0 / 35,000  
FH\*: 14,000 / 14,000

#### Dynamic Overturning

##### Moments: ft-lb (+/-)

MH: 1,220,000 / 1,220,000  
MV: 150,800 / 150,800  
MS: 1,220,000 / 1,220,000

Swing Torque: 75,400 ft-lb

### Metric

#### Static Overturning

##### Moments: kN-M (+/-)

MH\*: 827.0 / 0  
MV: 102.2 / 102.2  
MS\*: 827.0 / 827.0

##### Loads: kN (+/-)

FS\*: 62.3 / 62.3  
FV: 0 / 155.0  
FH\*: 62.3 / 62.3

#### Dynamic Overturning

##### Moments: kN-M (+/-)

MH: 1654.0 / 0  
MV: 204.4 / 204.4  
MS: 1654.0 / 1654.0

Swing Torque: 102.2 kN-M

(\*): FS or FH and MH or MS are swing function results and do not happen simultaneously

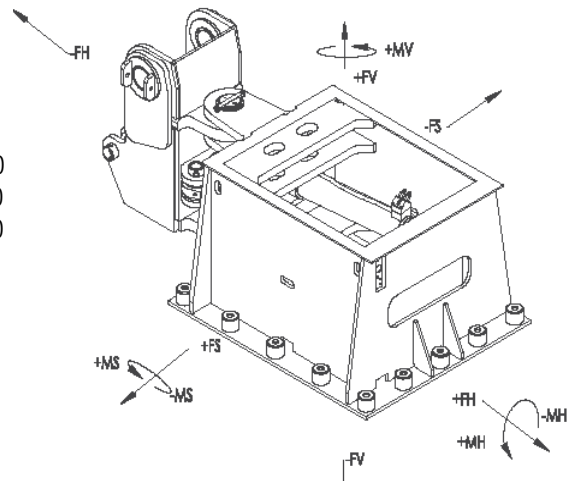

MRX24 – MRX30 – MRX3036 – MRX36

### Cross Sectional Data: Section Height x Width - in (mm)

	Hoist / Inner Boom	Dipperstick / Outer (Jib) Boom
MRX24.....	24.9 x 16.5 (632 x 419)	24.3 x 14.5 (616 x 361)
MRX30.....	29.4 x 16.5 (746 x 419)	25.6 x 14.2 (649 x 361)
MRX3036.....	29.4 x 16.5 (746 x 419)	27.9 x 14.2 (709 x 361)
MRX36.....	27.5 x 16.5 (698 x 419)	27.9 x 14.2 (709 x 361)

### Lifting Capacities: lb. (kg.)

MRX24.....	10,000 (4535)
MRX30.....	8,000 (3628)
MRX3036.....	7,350 (3333)
MRX36.....	6,700 (3039)

Calculated at full extension, value increases closer to the swing post



# MRX Series Pedestal Rock Breaker System

## HYDRAULIC and ELECTRICAL SYSTEMS

### Power Pack Specifications

Power Pack (PP) Model (Reservoir size - Hp)	PP100-100	PP100-100	PP100-125	PP100-125
Matched w/ Hammer Model	BX40	BXR50	BXR65	BXR85
Horsepower (kW)	100 (75)	100 (75)	125 (93)	125 (93)
Operating Weight: (w/o oil) lb. (kg.)	2400 (1090)	2400 (1090)	3000 (1364)	3000 (1364)
Dimensions: L x W x H in. (mm)	66 x 36 x 81 (1676 x 914 x 2057)	66 x 36 x 81 (1676 x 914 x 2057)	66 x 36 x 81 (1676 x 914 x 2057)	66 x 36 x 81 (1676 x 914 x 2057)
Max. Pump Flow gpm (lpm)	60 ( 227)	60 ( 227)	60 ( 227)	60 ( 227)
Regulated Pump Flow gpm (lpm)	42 (160)	54 (204)	60 ( 227)	75 (284)
Pump Pressure psi (bar)	3600 (250)	3600 (250)	4200 (290)	4200 (290)
Air-to-Oil Cooler c/w ½ HP motor (56T frame) ● c/w ¾ HP motor (56T frame) ▲	Standard	Standard	Standard	Standard

Note: ¾ HP oil cooler fan motor > 8,200 ft. (2500 m) a.s.l.

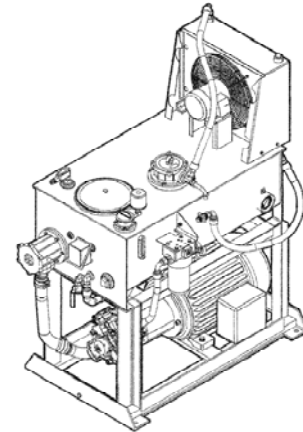

Filtration	Micron	Filtration Area sq. in. (sq. mm)	Flow Capacity gpm (lpm)	By-Pass psi (bar)	Maximum Pressure Rating psi (bar)
Pressure Filter	10	415 (2677)	147 (556)	75 (5)	5075 (350)
Return Filter	10	1100 (7100)	130 (490)	22 (1.5)	n/a
Suction Strainer	10	415 (2677)	60 (225)	75 (5)	6,000 (410)

Note: Power Pack Assembly also includes Pressurized reservoir capacity is 100 gal. (353 liters); Vent pressure relief is 4 psi (2.8 bar); Visual indicators provided on both pressure and return filters; low-oil level cut-off switch; pressurized filler cap., tank clean-out access cover; oil level gauge; temperature gauge; pump load sense bulkhead & connector, drain port & valve

Electric Motor (Pump Drive)	100 HP	125 HP
TEFC (IP55) Frame Size High Efficiency ● Prem. Efficiency ▲	404/5T	404/5T 444/5T
RPM / Service Factor	1800 / 1.25	1800 / 1.15
Efficiency & Power Factor @ 100%	95.4 / 87.0	95.8 / 88.0
AC Voltage / Phase / Hertz (other combinations available to suit site)	380 / 3 / 50 460 / 3 / 60 575 / 3 / 60	380 / 3 / 50 460 / 3 / 60 575 / 3 / 60
Current: Full Load / Locked Rotor (amps)	112 / 725	139 / 907
Torque: Full Load Torque ft-lb (N-m)	295 (400)	368 (499)

Note: NEMA Design B; Class "F" insulation; Altitude 3,300 ft. (1000 m) a.s.l.; Ball bearings; Continuous duty; Energy savings > EFF1 minimum efficiency (CC029A certification); Premium eff. meets IEEE841 standard; Constant HP control provides faster simultaneous boom functions w/o the need for a larger drive motor

### Power Pack (HPU) Options

Oil Tank Immersion Heater c/w thermostat; High/Low Temperature Sensor; Motor Starter Panel; Recirculation Valve; High Altitude Provision; Motor Deration Package in 3,281 ft. (1000 meters); Drip tray; Hand pump; Motor Terminal Blocks; Water-over-Air Cooler pkg.; Cold Weather Conversion Kit

### IQAN (can-bus) Remote Controls

- Sturdy Framed Stand Mounted Joystick controller – 48 in. (1219 mm) height
- 2-Dual Axis Joysticks – R.H. Thumb Hammer Op.
- SAE Mapping / Excavator Control Pattern
- Remote start/ stop of power unit (pump motor)
- NEMA 12 (CSA Type 12) Enclosures
- 120/240 VAC Power supply
- 24 VDC , 156W, 6.5 A Control power
- Inputs:
  - 8 V voltage inputs
  - 0-5 VDC signal range
  - 1.2 mV resolution
  - 5(1) digital inputs
  - >4 VDC / <= 1 VDC (high/low signal)
  - 400 mA; 32 VAC resistive load switching current
- Outputs:
  - 1 digital output
  - 200 mA max. load.
- Resistance temperature detector (RTD) mounted to HPU
  - measures oil temperature within HPU
  - controls cooler fan motor and immersion heater
  - Provides high/low temperature shutdown



#### Distance ft. (m)

- Parker IQAN (can-bus) - 328 (30) max. ●
- Radio Remote additional option - 328 (30) max. ▲

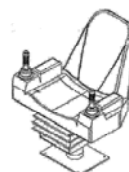
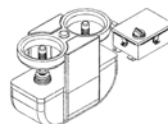

#### Deluxe controls options: ▲

- Coaxial Cable (Pan-Zoom Camera) option – 1,500 (457)
- Fiber Optics (Pan-Zoom Camera) option – 7 miles (11.2K m)

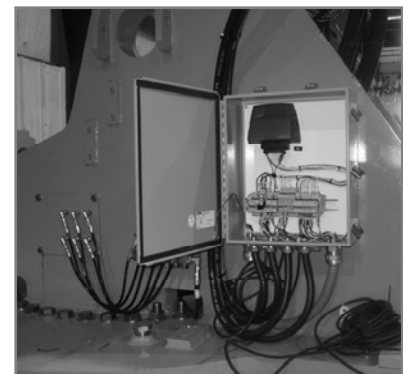



# MRX Series Pedestal Rock Breaker System

## ROCKBREAKER SYSTEM STANDARD FEATURES

### Notes:

● Standard    ▲ Optional

### Power Packs

- • 100 HP & 125 HP power pack for BX40/BXR50/65 & BXR85 respectively for heavy duty requirement
- • High efficient grade main pump drive motor
- ▲ • Premium efficient (IEEE841) main pump drive motor (optional energy efficient)
- • Main electric motor altitude acceptance limit: 3,280 ft. (1000 m)
- ▲ • High Altitude: motor impeller charge kit > 5,000 ft (1,500 m); and
- ▲ • High Altitude: motor altitude deration, provided in 1000 m increments > 3,280 ft. (1000 m) up 16,400 ft. (5000 m)
- ▲ • Continuous oil circulation valve for high duty & temperature applications
- ▲ • High/low temperature sensor
- ▲ • Immersion heater – 2kW (circuit breaker & contactor optional with starter panel)
- ▲ • Motor Starter panel (100, 125 or 150 HP mounting & wiring also optional)
- / ▲ • Remote power pack start / stop panel with indicator switches and lamps
- • Air-to-oil cooler with thermostatic control
- ▲ • Water-over-oil cooler c/w thermostatic control
- / ▲ • Cold weather conversion kit (with dual immersion heaters, heat tape, etc.)
- ▲ • 15 ft. (4.6 m) Supply hoses –optional longer lengths up to 25 ft. (7.6 m)

### Control System:

- • IQAN (can-bus) stand mounted joystick controller package w/ PP on/off provision
- • < 328 ft. (100 m) remote control cable (IQAN)
- • RTD measures oil temp., controls cooler, heater and temperature shutdown
- ▲ • IQAN override handles for mechanical positioning (installation & maintenance)
- ▲ • Hand-held Radio Remote (transmitter-receiver) joystick controller package
- ▲ • < 328 ft. (100 m) control distance / signal strength (radio remote)
- ▲ • Secondary stand mounted controls
- ▲ • < 1,500 ft. (457 m) coaxial cable – central control c/w pan-zoom cameras
- ▲ • < 7 mi. (11.26 km) fiber optic cable – central control cw pan-zoom cameras

### Greasing System: (2-grease system: moly / lithium for boom, chisel past for hammer)

- • Individual / point-to-point manual greasing of boom and hammer
- ▲ • Manual-Centralized Grease system; Hydraulic auto lubrication system
- ▲ • Pneumatic auto lubrication system

### Pedestal Boom and Hammer Units

- ▲ • Counter-balance valve package
- ▲ • Anti-Lunge provision
- ▲ • Anti-Blank fire provision
- ▲ • Fire suppression system (Ansul: manual, "Automan" or "Check-fire")
- • Hammer blunt tool – (optional choice of chisel ormoil)
- ▲ • Hammer severe duty wear kit with rock claws (separate claws also optional)

# MRX Series Pedestal Rock Breaker System

## OPTIONS ▲

### BOOM

- All hose system
- Counter balance valves
- Anti-lunge protection
- Anti-blank fire interlock
- Foundation interface mounting  
- concrete or steel structure
- Greasing systems  
- manual, hydraulic or pneumatic
- Fire Suppression (Ansul)
- Explosion proof valve/circuit
- Auxiliary hydraulic circuit
- Steel isolator mounting
- Customized base mounting\*
- Swing stops & alt. positioning
- Expander pin provision
- Spring guard hose covering
- Start-up / commissioning svc.
- Installation supervision



(\*) Expander pin provision

### POWER PACK

- Premium efficient motor
- Immersion heater
- Continuous circulation valve
- Cold weather conversion kits
- Motor Starter Panel  
- additional mounting & wiring
- Cooler Package (for BX20)  
- air-to-oil or water-to-oil
- Motor deration package
- High altitude provision
- Motor terminal blocks
- Explosion proof motor
- Hand pump / Drip tray
- Drip tray
- Dust enclosure w/ ventilation\*



(\*) Dust enclosure w/ ventilation

### CONTROLS

- IQAN override handles
- Secondary stand mtg. controls
- Radio remote controls
- Ergonomic chair c/w controls\*
- Coaxial cable system\*  
- central pan-zoom camera control
- Fiber optics system\*  
- central pan-zoom camera control



(\*) Ergonomic seat / coax / fiber optics systems

### HAMMER

- Severe duty wear kit\*
- Rock claws kit
- Mechanic quick coupler
- Concave removal tool
- Spare Tools  
- blunt, chisel,moil
- Chisel paste  
- single tube or case or 5 gal. pail
- Extension mounting bracket

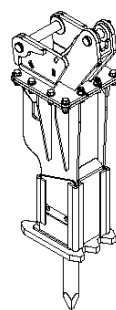

(\*) Severe Duty Wear Kit  
c/w Rock Claws

### MISCELLANEOUS

- 30 in (762 mm) bucket
- Quick Coupler-bucket
- Hydraulic positioner & circuit
- Control cabin (medium or large)\*
- Control cabin options  
- a/c; heater; extra door/window; etc.
- Miscellaneous attachments:  
- picks, grapples, stone grabs, etc.

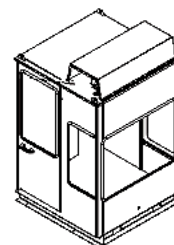

(\*) Control Cab  
c/w A/C

A BTI representative is available to review your rock breaker project requirements and provide a site visit and assessment of your material flow conditions. BTI has a policy of continuous product improvement and reserves the right to revise or change designs and specifications at any time without obligation.

*Authorized Dealer*



**BREAKER TECHNOLOGY** an Astec Industries Company

UNITED STATES EAST 440.248.7168 • UNITED STATES WEST 951.369.0878 • CANADA/INTERNATIONAL 519.599.2015 • rockbreaker.com





## Rockbreaker Boom Systems Warranty Policy

REV 09/04

# WARRANTY POLICY

1. BREAKER TECHNOLOGY INC. Company (hereinafter referred to as "BTI") warrants this product against defects in materials and workmanship for a period of twelve (12) months or 2000 hours from the date of installation, or 18 months from the date of shipment, whichever comes first. This warranty does not cover o-rings, seals, fittings, hoses, breaker tools or other items considered normal wear items. These are covered by the Limited Warranty period of thirty (30) days. Warranty for propriety items such as valves, pumps, filters, electric motors, panels and componentry that are not manufactured by BTI, will be governed by the warranty terms of their manufacturer. This warranty is void if BTI's standard installation specifications and procedures are not adhered to.
2. BTI will authorize return of any defective components or sufficient evidence of such defect to a BTI warehouse. Such components or such evidence must clearly show that the defect was caused by faulty material or poor workmanship. Warranty claim will be accepted only if it is submitted on a proper claims form with proof of purchase and received within sixty (60) days from the date of discovery of the defect. Warranty claims will be considered only if the "Installation Notice" has been duly filled in and returned to BTI within thirty (30) days from the date of installation.
3. BTI will at it's option, repair or refurbish the defective part(s) without charge to the initial user or may elect to issue full or partial credit toward the purchase of a new part(s). The extent of credit issued, which will be in the form of a "Credit Memo", will be determined by pro-rating against the normal life of the part(s) in question.
4. BTI is not responsible for mileage, travel time, travel expenses, overtime labor, and any freight expenses required to facilitate the repair.
5. This warranty does not apply if the product has been damaged by accident, abuse, misuse, misapplication or neglect, or as a result of service, disassembly or modification, without BTI's express authorization.
6. BTI assumes no liability beyond the replacement of defective parts or materials and/or the correction of such defective parts or materials.
7. BTI neither assumes nor authorizes any other person to assume for it any liability in connection with the sale of its products other than that specifically stated herein.
8. THIS WARRANTY IS EXPRESSLY IN LIEU OF ANY AND ALL OTHER WARRANTIES. EXCEPT AS EXPRESSLY SET FORTH HEREIN, BTI MAKES NO REPRESENTATION OR WARRANTY, STATUTORY, EXPRESS OR IMPLIED, WITH RESPECT TO THE PRODUCTS MANUFACTURED AND/OR SUPPLIED BY BTI, WHETHER AS TO MERCHANTABILITY, FITNESS FOR A PARTICULAR PURPOSE OR ANY OTHER MATTER. IN NO EVENT, INCLUDING IN THE CASE OF A CLAIM OF NEGLIGENCE, SHALL BTI BE LIABLE FOR INCIDENTAL OR CONSEQUENTIAL DAMAGES.

[www.rockbreaker.com](http://www.rockbreaker.com)

**Breaker Technology, Inc.**  
30625 Solon Industrial Pkwy.  
Solon, Ohio 44139 USA  
(440) 248-7168 / 8645 Ph. / Fx.

**Breaker Technology, Inc.**  
3453 Durahart Street  
Riverside, CA 92507  
(951) 369-0878 / 8281 Ph. / Fx.

**Breaker Technology Ltd.**  
35 Elgin Street North  
Thornbury, Ontario N0H 2P0  
(519) 599-2015 / 6803 Ph. / Fx.

**BREAKER TECHNOLOGY** an Astec Industries Company

UNITED STATES EAST 440.248.7168 • UNITED STATES WEST 951.369.0878 • CANADA/INTERNATIONAL 519.599.2015 • [rockbreaker.com](http://rockbreaker.com)

